

Fibo

Monteringsanvisning veggpanel - steg 1-5 Installation instruction wall panel - step 1-5



Installation in both
Norwegian and English



WALLS BUILT FOR LIFE

For å sikre holdbarhet på dine vegger i flere tiår, er Fibo veggpanel produsert med en kjerne av kryssfiner mellom balanselaminat i bakkant og et dekorativt høytrykkslaminat i front og som er enkelt å rengjøre og vedlikeholde. Fibo Aqualock gir enkel montering og et varig resultat.

To ensure that your walls are durable and will last for decades, Fibo wall panels are made from a plywood core layered between a balancing layer and a decorative high pressure laminate that is easy to clean and maintain. Fibo Aqualock makes the installation easy and provide a consistent result.

Inspirasjon og monteringsfilmer på fibo.no
Inspiration and installation videos at fibosystem.com
E-mail: info@fibosystem.com



FIBO MONTERINGSANVISNING

FIBO INSTALLATION INSTRUCTION

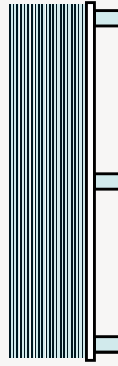

Lagring | Storage

Lagre panelene tørt og liggende i emballasjen frem til montering.

Keep panels dry stored and flat in package until installation.

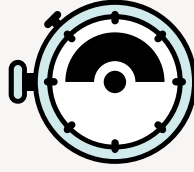

Min. 72 timer | Min. 72 hours

Akklimatiser emballerte paneler i romtemperatur i minst 72 timer (mer hvis de har vært på kaldt lager).
Luftfuktigheten i rommet må være mer enn 30% både under og etter montering.

Store panels in package in room conditions for at least 72 hour acclimatization (longer if they have been kept in a cold area). Humidity in the room must be above 30% during installation.

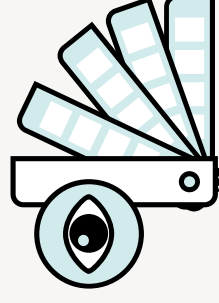

Visuell kontroll | Visual control

Kontroller farge og sjekk for andre feil før montering.

Colourmatch and check for flaws before installation



FIBO TILBEHØR FIBO ACCESSORIES

WALLS BUILT FOR LIFE

1. Fibo Magic Sponge
2. Fibo Sealing Tools
3. Fibo Tapping Tool
4. Fibo Screws
5. Fibo Wipes
6. Fibo Clean
7. Fibo Seal (White, Grey, Black)
8. Fibo Grip

Vask bort rester fra
Fibo Wipes umiddelbart
med såpevann!
Remove residue from Fibo Wipes
immediately with soap water!





FIBO TILBEHØR: ALU PROFILER

FIBO ACCESSORIES: ALU PROFILES

WALLS BUILT FOR LIFE

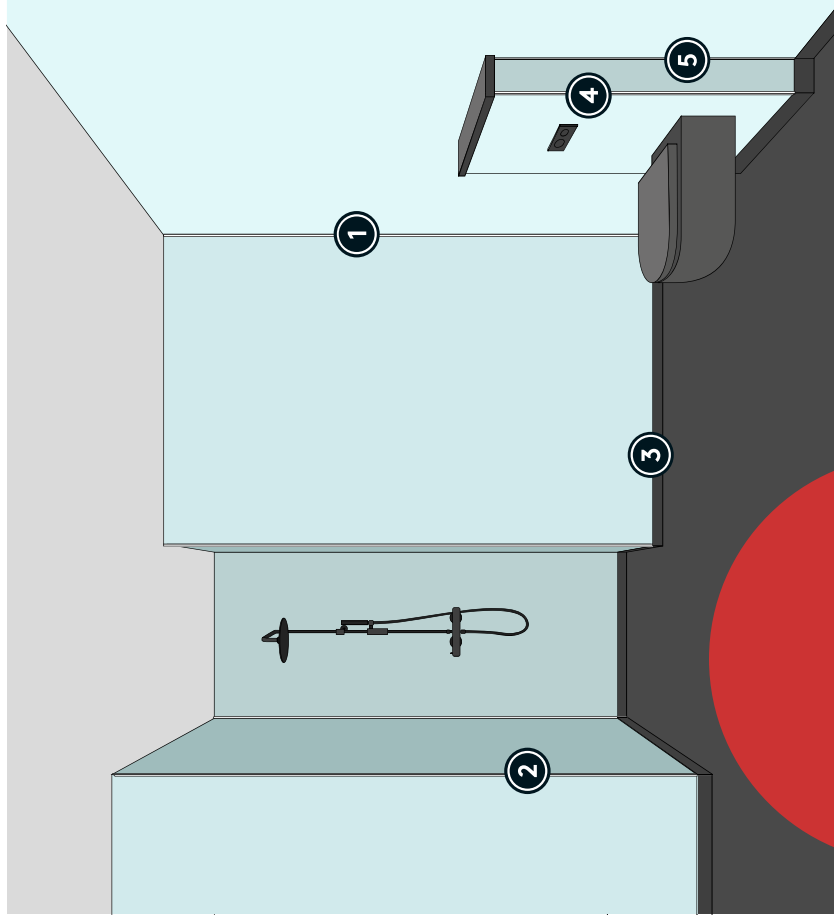

Fibo erstatter dampperre på yttervegg når alle overganger er forseglet.

Fibo replaces vapor barrier when all joints are sealed.

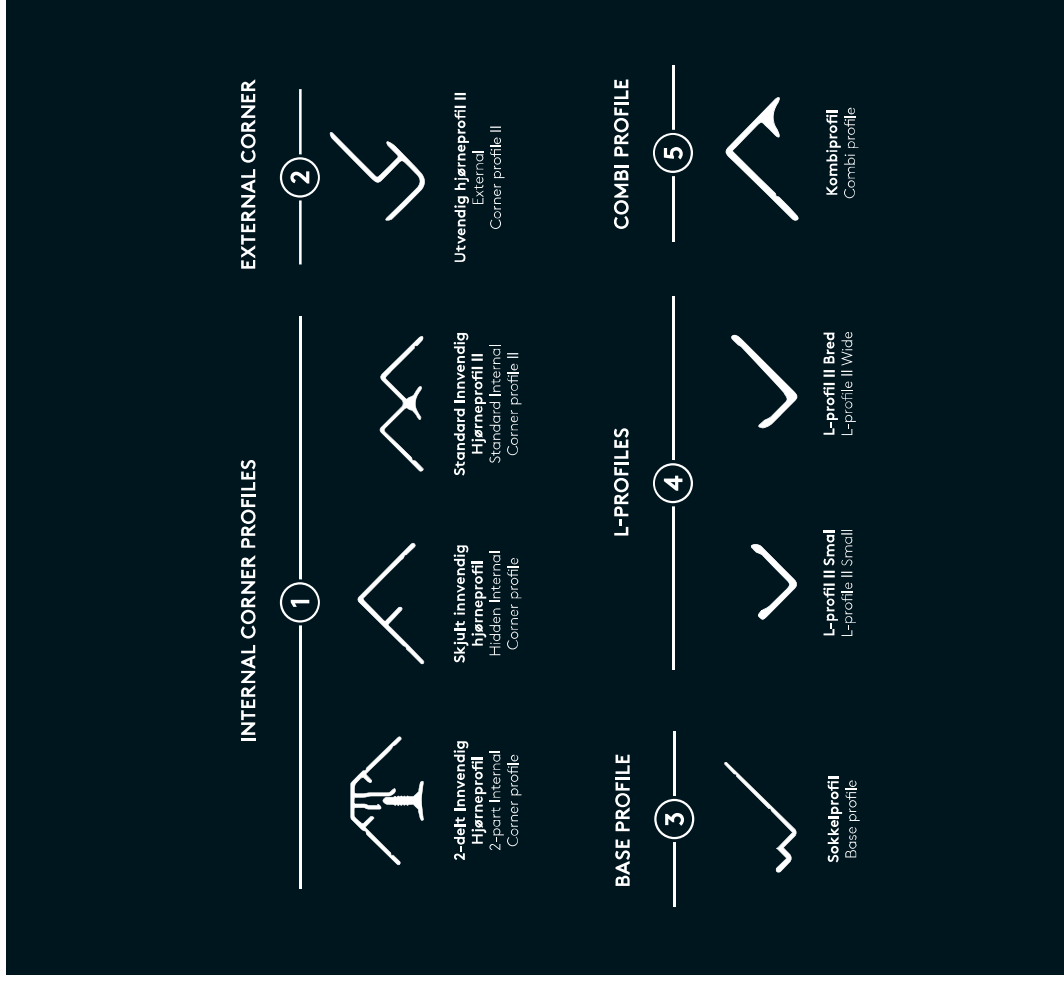



VERKTØY DU TRENGER TOOLS YOU NEED

Batteridrill med T10 bit og bor
Screwdriver with T10 bit and drill

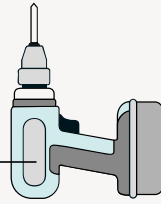

Fugepistol
Caulking gun

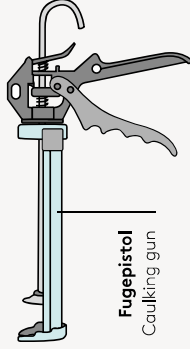

Fintannet sag eller sirkelsag
Track saw or Circular saw

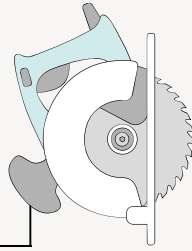

Tommestokk
Ruler

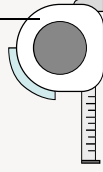

Blyant
Pencil

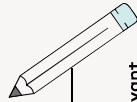

Hullsag/Stikksag for dusjhode/rørgjennomføring
Hole saw/Jigsaw for shower heads/pipe penetrations

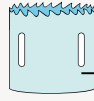

Vater eller laser
Level or laser

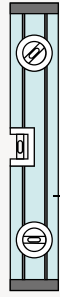

TETTING AV SKRUEHULL COVERING SCRE WHOLE

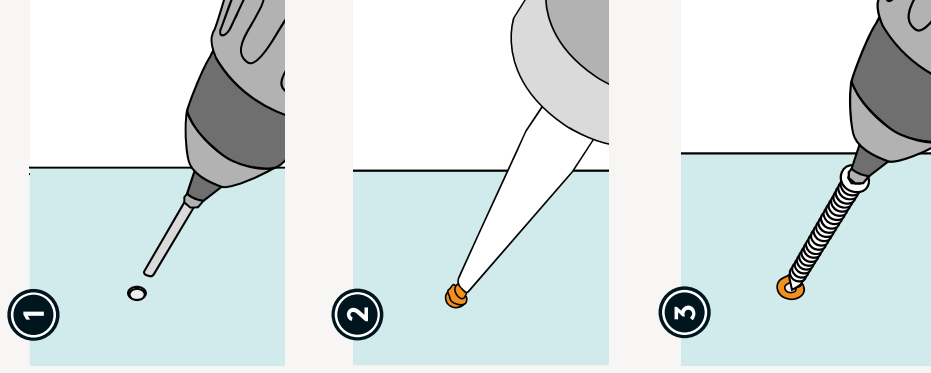

KUTTING AV PANEL CUTTING PANELS

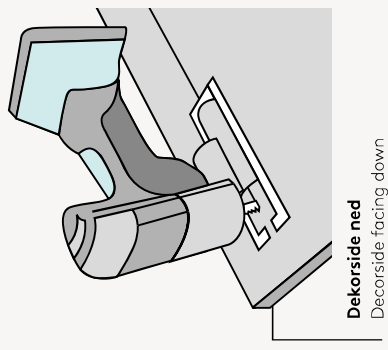
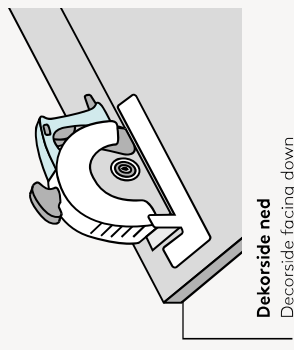

ADVARSEL: Verktøy må håndteres med forsiktighet for å unngå skade på paneler.
WARNING: Power tools must be used with caution to prevent damaged panels.





CLEANING & MAINTENANCE

RENGJØRING & VEDLIKEHOLD

RENGJØRING & VEDLIKEHOLD

Forleng fugemassens levetid ved korrekt rengjøring, i henhold til FDV på fibo.no. Spesielt fugemasse i sokkelprofil og skjult innvendig hjørne for fuging bør rengjøres regelmessig. Hvis fugemasse blir sprø eller skadet over tid, må den behandles umiddelbart.

Fuktet melaminsvamp (Fibo Sponge) kan brukes på særlig vanskelige flekker. Følg bruksanvisning på produktets emballasje.

CLEANING & MAINTENANCE

For watertight system, apply Fibo Seal as shown beneath. All cutting surfaces and bottom edge of panel must be sealed, also when drilling holes for pipe penetration. Incorrect installation will void your warranty. Use Fibo Clean and Fibo Wipes to remove excessive sealant. Film from cleaning accessories shall be removed immediately from panel surface.





HVORDAN FORSEGLE OG FUGE FIBO VEGGPANEL

HOW TO PRESEAL AND SEAL FIBO WALL PANELS

HVORDAN FORSEGLE OG FUGE FIBO VEGGPANEL

For vannrett system, påfør Fibo Seal som vist under. Alle kuttflater og kryssfiner i bunn av panel skal forsegles også ved hulltaking til rørgjennomføring. Ved mangelfull montering bortfaller garanti. Bruk Fibo Clean og Fibo Wipes for å fjerne overflødig fugemasse. Film fra rengjøringsmiddel skal fjernes umiddelbart fra panelene.

HOW TO PRESEAL AND SEAL FIBO WALL PANELS

For watertight system, apply Fibo Seal as shown beneath. All cutting surfaces and bottom edge of panel must be sealed, also when drilling holes for pipe penetration. Incorrect installation will void your warranty. Use Fibo Clean and Fibo Wipes to remove excessive sealant. Film from cleaning accessories shall be removed immediately from panel surface.

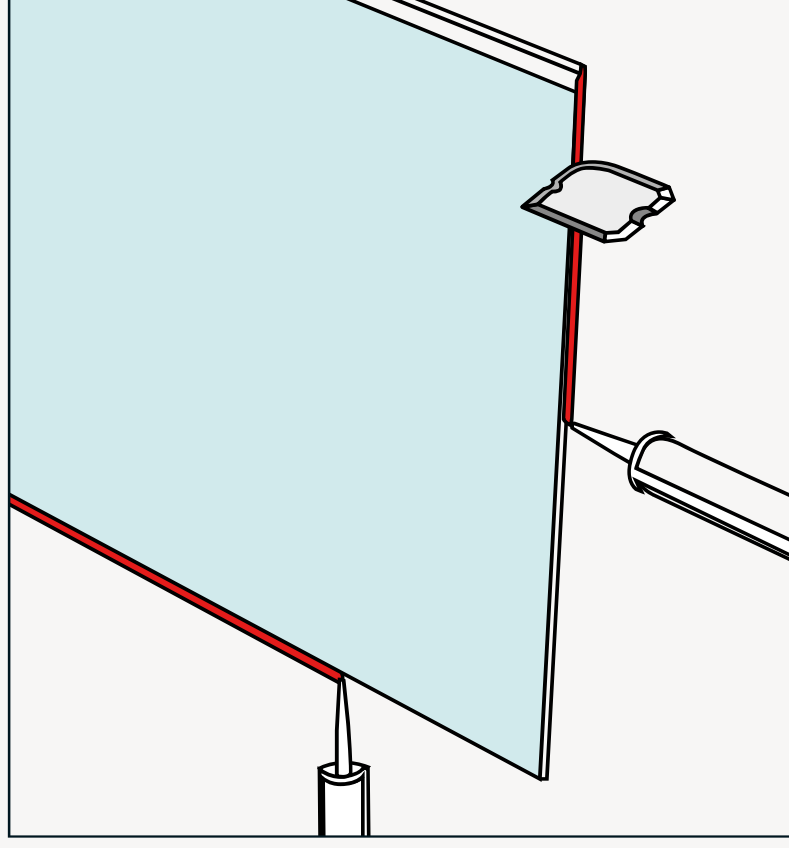
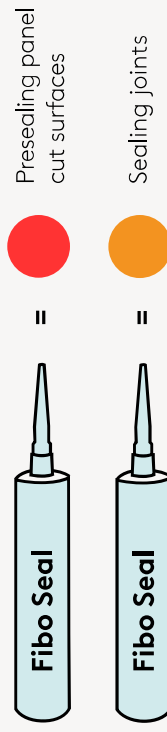

1A

VELG RIKTIG BAKVEGG BACKWALL OPTIONS

Benytt ekstra støtte i bakvegg dersom det skal monteres tunge gjenstander som skap, toalett, dusjsete, støttehåndtak eller lignende. Planhetstoleranse: Maksimalt planhetsavvik på +/-2 mm/2 meter. Det er ikke behov for dampsperre eller membran bak veggpanelene.

Extra support in backwall must be used if heavy objects such as cabinets, toilets, shower seats, support handles or similar is to be installed. Flatness tolerance: Maximum flatness deviation of +/-2 mm/2 meters. There is no need for extra membrane behind our wall panels.

A
Wooden stud
Stendere

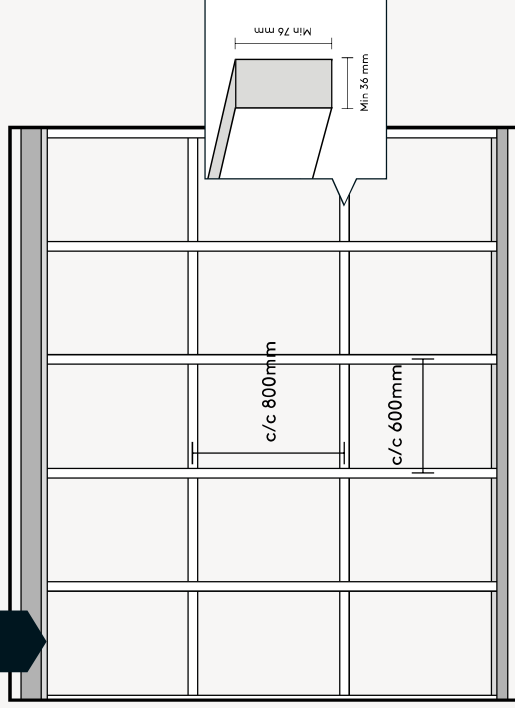

B
Construction plywood / OSB class 3
Kryssfinér / OSB klasse 3

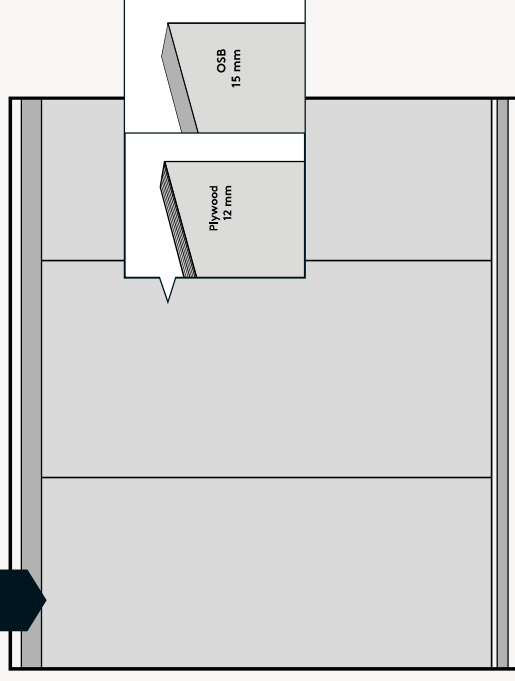

1B

VELG RIKTIG BAKVEGG BACKWALL OPTIONS

Benytt ekstra støtte i bakvegg dersom det skal monteres tunge gjenstander som skap, toalett, dusjsete, støttehåndtak eller lignende. Planhetstoleranse: Maksimalt planhetsavvik på +/-2 mm/2 meter. Det er ikke behov for dampsperre eller membran bak veggpanelene.

Extra support in backwall must be used if heavy objects such as cabinets, toilets, shower seats, support handles or similar is to be installed. Flatness tolerance: Maximum flatness deviation of +/-2 mm/2 meters. There is no need for extra membrane behind our wall panels.

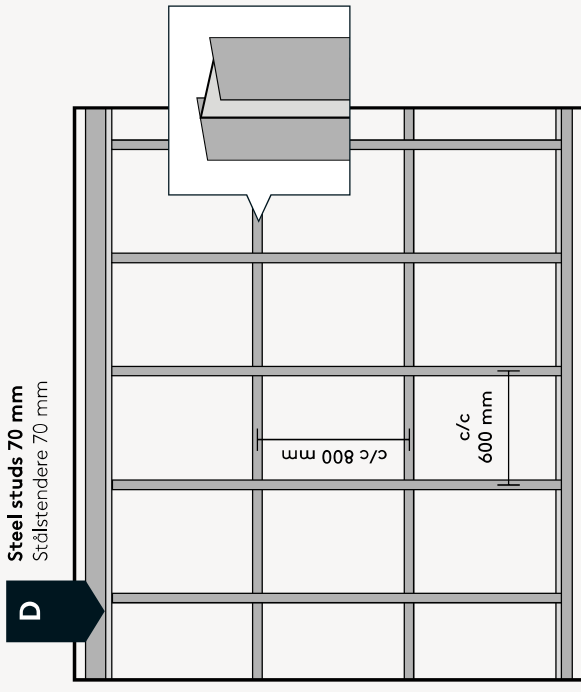
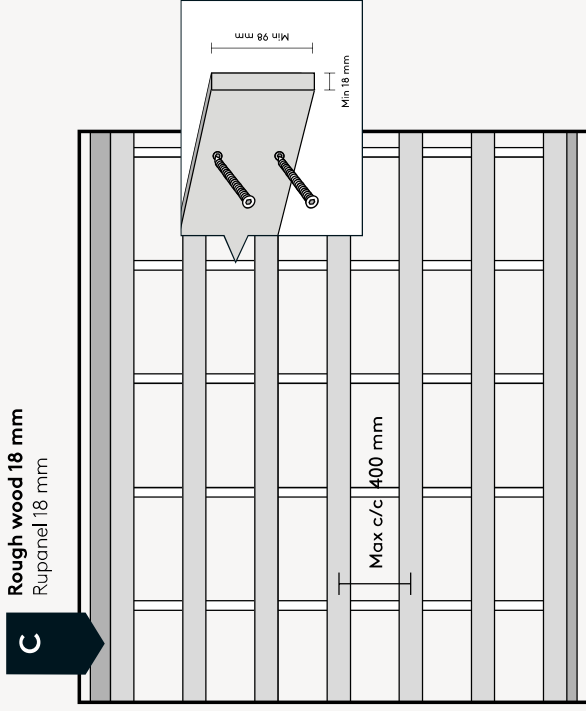

Benytt ekstra støtte i bakvegg dersom det skal monteres tunge gjenstander som skap, toalett, dusjsete, støtteåndtak eller lignende. Planhetstoleranse: Maksimalt planhetsavvik på +/-2 mm/2 meter. Det er ikke behov for dampsperre eller membran bak veggpanelene.

Extra support in backwall must be used if heavy objects such as cabinets, toilets, shower seats, support handles or similar is to be installed. Flatness tolerance: Maximum flatness deviation of +/-2 mm/2 meters. There is no need for extra membrane behind our wall panels.

E Betongvegg med Fibo skruer
Concrete wall with Fibo Screws

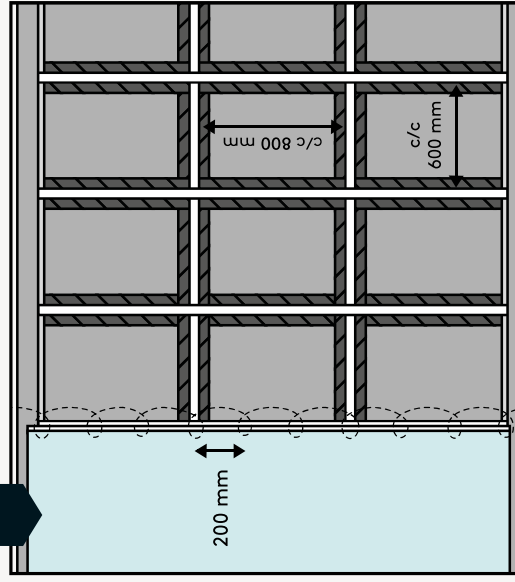

Ved montering på betong- eller teglvegger med skruer skal panelene festes til vertikale og horisontale lektre med dimensjoner min. 23 mm x 48 mm. Lektene skal monteres c/c 0,8 m med bred side mot vegg, med kapillært hindrende lag mellom de innerste lektene og betongveggen.

When installed on concrete or brick walls with screws, the panels shall be fixed to vertical and horizontal battens with dimensions min. 23 mm x 48 mm. The battens shall be installed c/c 0,8 m with the wide side flat, with a capillary obstructing layer between the inner battens and the concrete wall.

F Liming på betongvegg
Adhesive on concrete wall

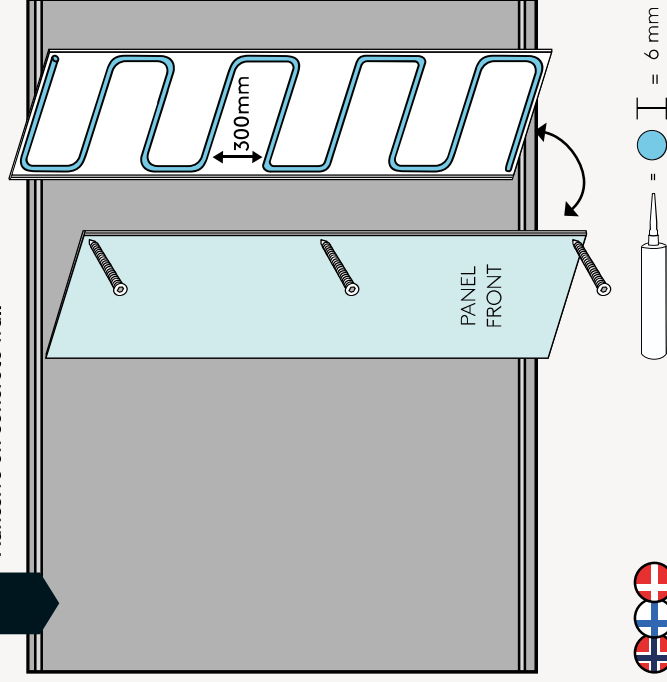

Fibo Seal in combination with screws, or glue with initial grab. Make sure to screw the first panel as shown.

Ved liming av panel til vegg av betong, sørg for at veggen er tørr (RH < 85% / CIM < 2%), jevn og rengjort. Husk skruer på første panel - se figur.

2

ULIKE LØSNINGER FOR RØRGJENNOMFØRINGER DIFFERENT PIPE SOLUTIONS

Kuttflater skal forsegles ved hulltaking til rørgjennomføring. For fullstendig monteringsanvisning av EAD 030437-00-0503 godkjente løsninger, Tølg veggboaks-produzentenes anvisninger. Godkjenning av PP- og kobberør er dokumentert i SINTEF Teknisk Godkjenning 2289.

Cutting surfaces must be sealed when drilling holes for pipe penetration. For complete installation guidance, follow the wall box producers' instructions. The ones illustrated are EAD 030437-00-0503 approved systems. Approval for PP- and copper pipes is documented through SINTEF Technical Approval 2289.

Første steg i alle tilfeller
First step in all cases

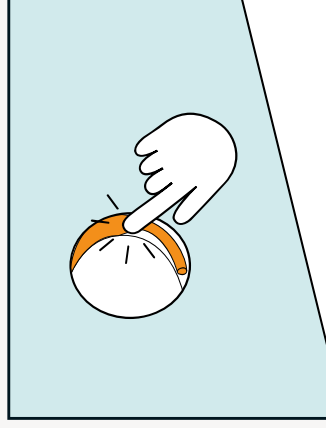

A
Sanipex/Roth
Bruk av gjenget tettering

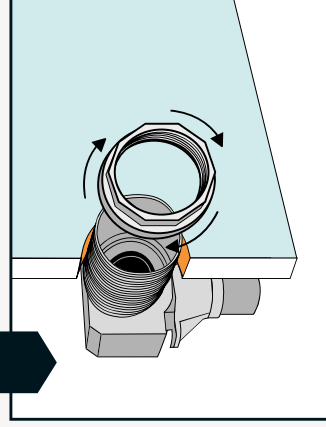

B
PP- og PVC-rør, 110 mm
PP- and PVC pipes, 110 mm

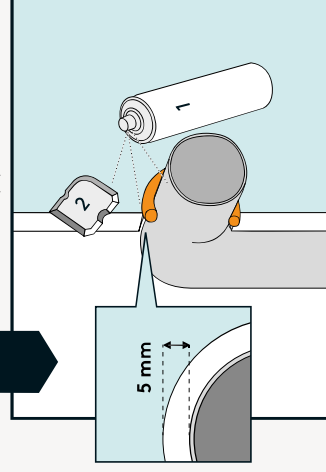

C
Kobberør
Copper pipes

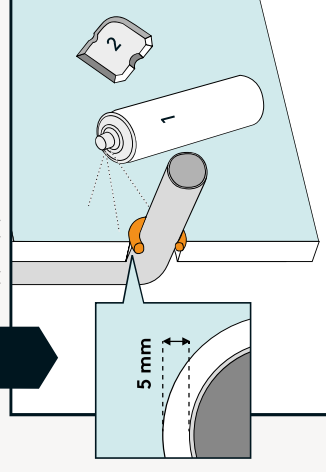

3

SKJØTEPROFIL | UTVENDIG HJØRNEPROFIL | AVSLUTNING MOT TAK STACKING PROFILE | EXTERNAL CORNER PROFILE | SEALING FINISH

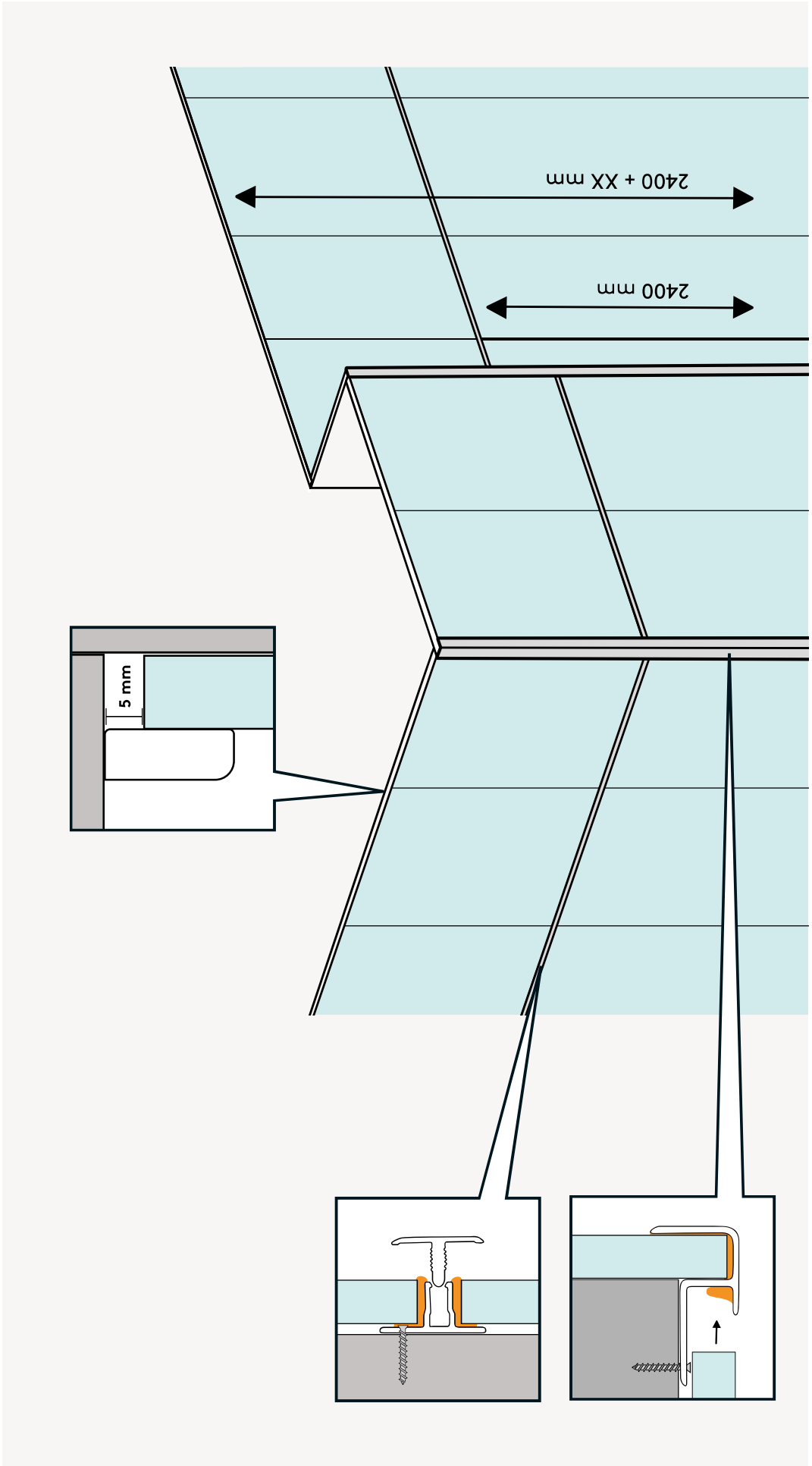

4A

AVSLUTNING MOT GULVMEMBRAN CHOOSE TRANSITION TO FLOOR MEMBRANE

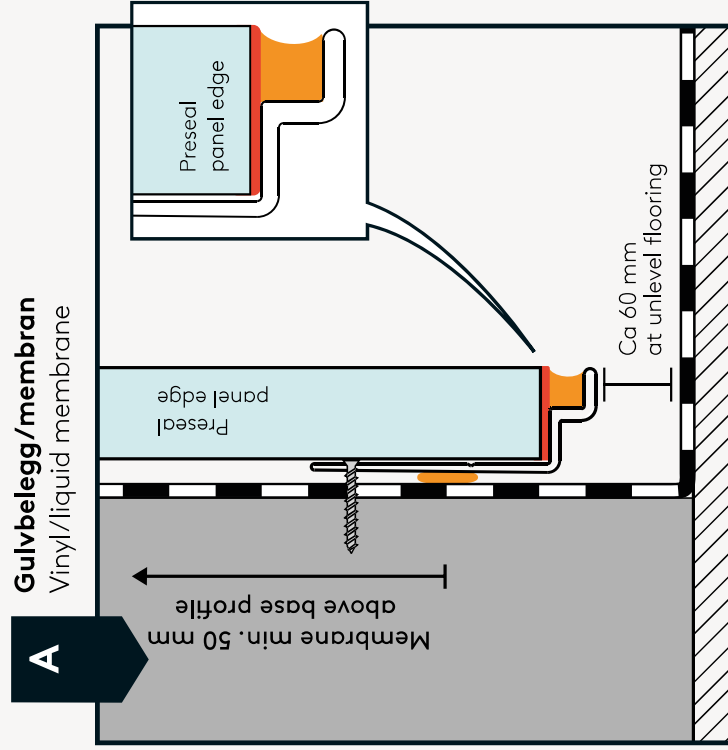

Universelt godkjente løsninger, testet i henhold til EAD 030437-00-0503.
Universal approved solutions, tested according to EAD 030437-00-0503.



Sealing of panel lip, marked in orange.



Presealing of panel edge, marked in red.

EAD 030437-00-0503 er referert til i:
EAD 030437-00-0503 is referred to in:



BVN 34.510

4B

AVSLUTNING MOT GULVMEMBRAN CHOOSE TRANSITION TO FLOOR MEMBRANE

B

Sokkelflis med membran
Skirting tile with membrane

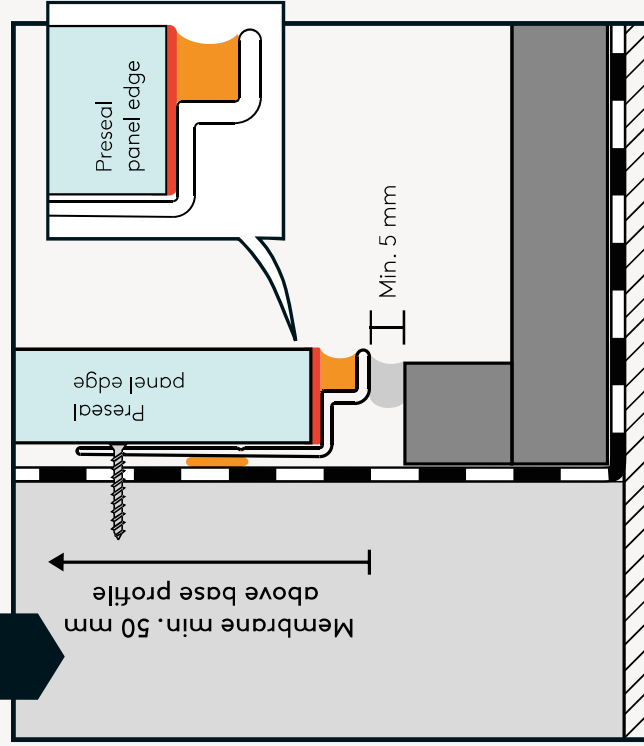

Universelt godkjente løsninger, testet i henhold til EAD 030437-00-0503.
Universal approved solutions, tested according to EAD 030437-00-0503.



Sealing of panel lip, marked in orange.



Presealing of panel edge, marked in red.

EAD 030437-00-0503 er referert til i:
EAD 030437-00-0503 is referred to in:

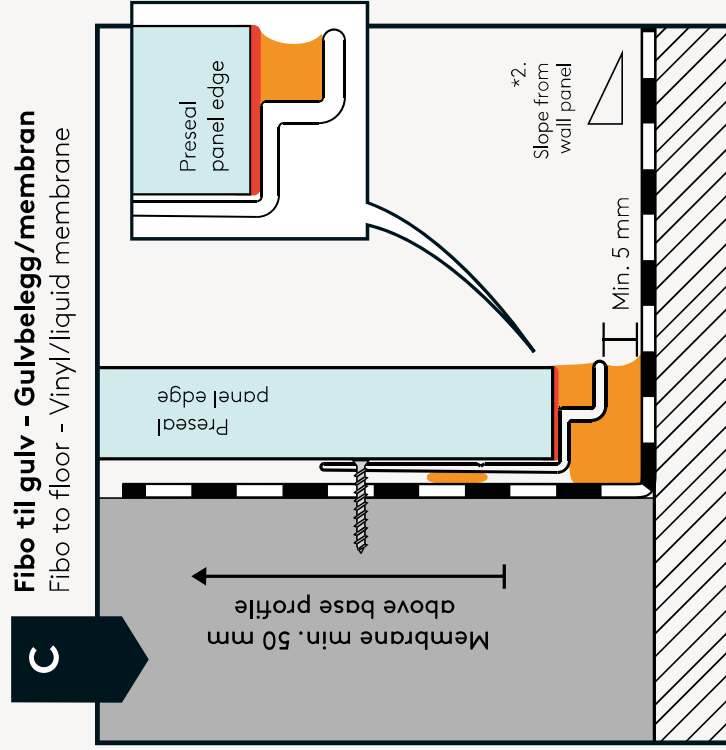

Fibo til golv - Gulvbelegg/membran
 Fibo to floor - Vinyl/liquid membrane

Universelt godkjente løsninger, testet i henhold til EAD 030437-00-0503.
 Universal approved solutions, tested according to EAD 030437-00-0503.



Krav ved montering til golv:

1. Gulvet hvor sokkelprofil monteres må være i vater
2. Gulvet må ha helning fra vegg mot sluk
3. Fibo Seal bør påføres mellom sokkelprofil og golv for å unngå oppsamling av smuss

Requirements for installation to floor:

1. The floor must be level where the base profile is installed
2. The floor must obtain a slope from the wall towards the drainage point
3. Sealant should be applied between base profile and flooring to maintain sanitary conditions

EAD 030437-00-0503 er referert til i:  **BVN 34.510**
 EAD 030437-00-0503 is referred to in:

5A

MONTERING MED TO-DELT INNVEDIG HJØRNEPROFIL INSTALLATION WITH TWO-PART INTERNAL CORNER PROFILE



Velv en av våre hjørneprofiler: To-delt, skjult eller standard
Choose one of the following Corner Profiles: Two-part, hidden or standard

NB: Det anbefales bruk av vuggende bevegelse når man klikker panelene sammen for å sikre en god sammenføyning av Aqualock. Bruk av Fibo Grip vil gi økt kontroll under sammenføyning. Ved behov kan man slå forsiktig mot spikerleppen på høyre side av panelet med Fibo Tapping Tool for å sikre at panelet er helt i lås.
NB: It is recommended to use a cradling movement back and forth when clicking the panels together to ensure a good joining of the Aqualock. Using Fibo Grip will give increased control during joining. If necessary, you can carefully tap the nail lip on the right side of the panel with the Fibo Tapping Tool to ensure that the panel is completely locked.

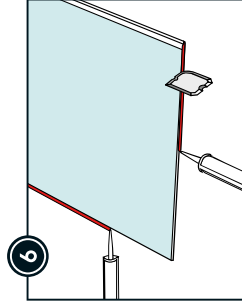
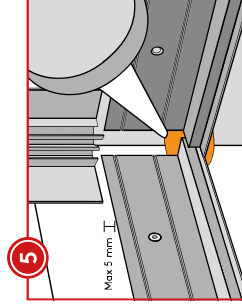
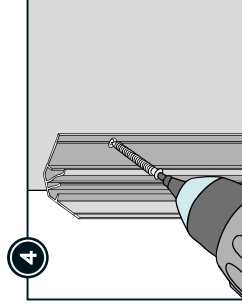
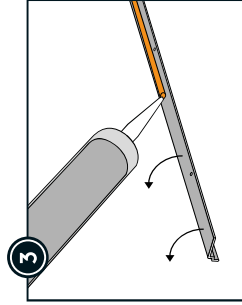
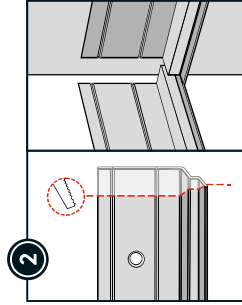
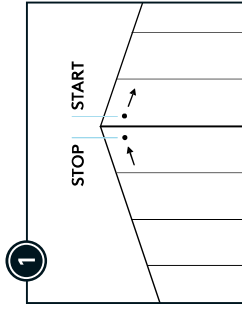

Crucial step to ensure a watertight result.

Preseal cut surfaces and panel bottom edge.

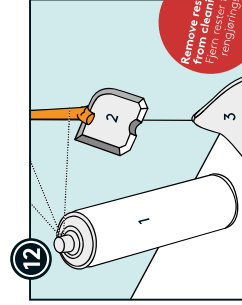
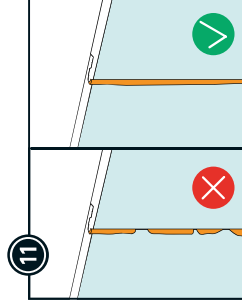
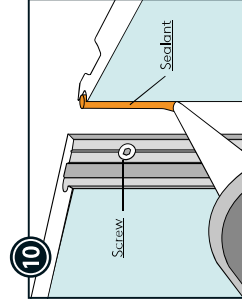
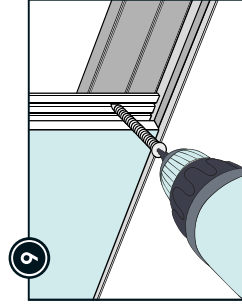
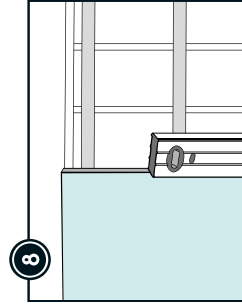
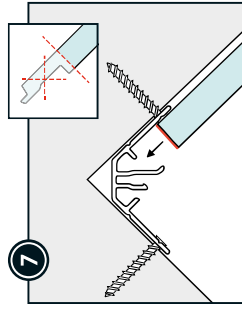

Remove Aqualock and preseal cut edges.

First screw through base profile.

Screw distance c/c 200 mm. Mind the force of drilling to avoid excessive screw penetration.

Avoid use of excessive force when installing. This may harm the Aqualock.

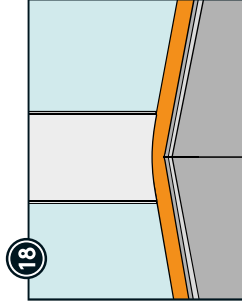
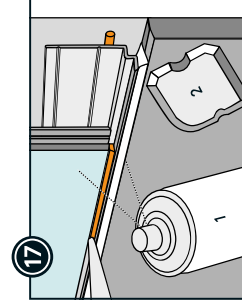
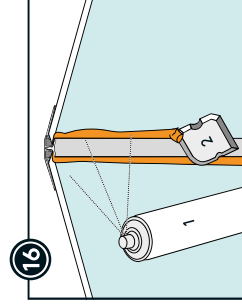
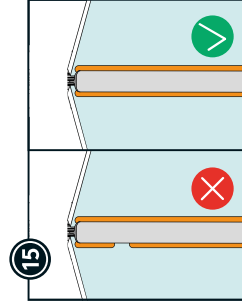
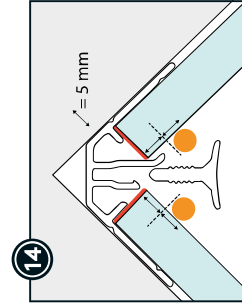
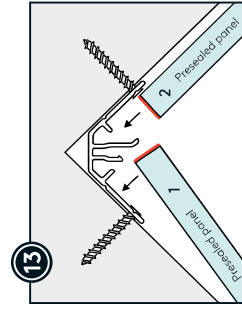

Do not place corner profile further down than this.

5B

MONTERING MED SKJULT INNVEDIG HJØRNEPROFIL INSTALLATION WITH HIDDEN INTERNAL CORNER PROFILE



Velg en av våre hjørneprofiler: To-delt, skjult eller standard
Choose one of the following Corner Profiles: Two-part, hidden or standard

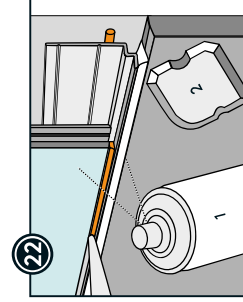
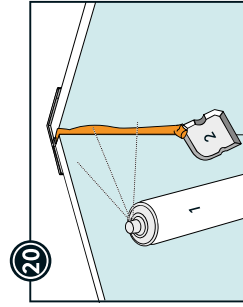
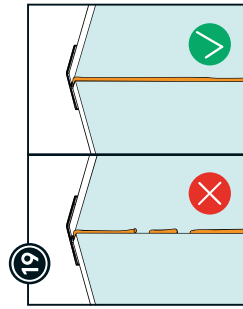
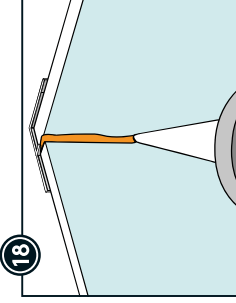
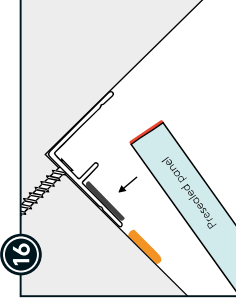
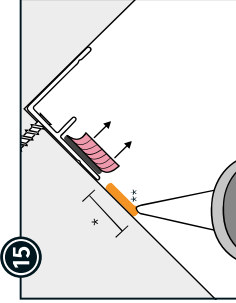
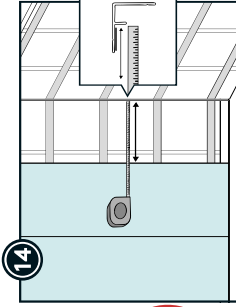
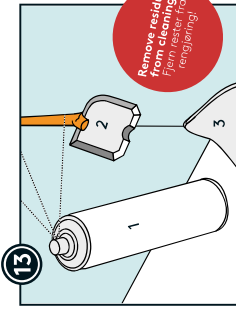
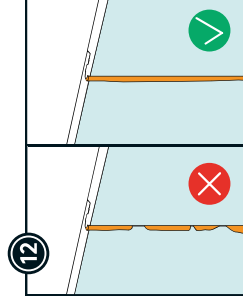
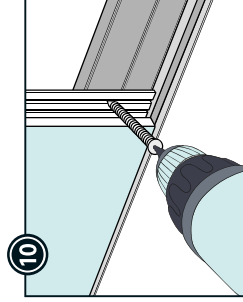
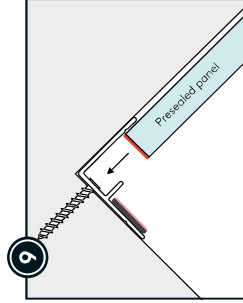
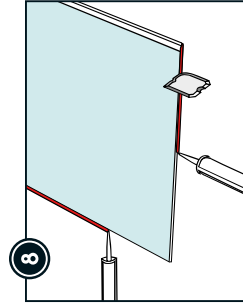
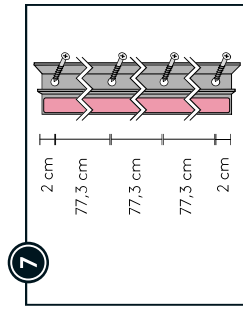
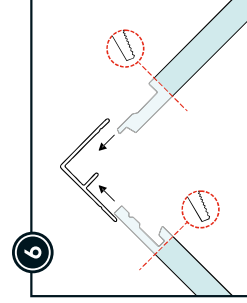
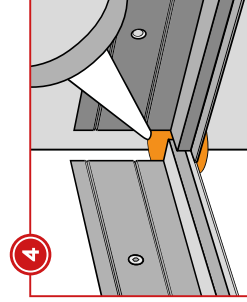
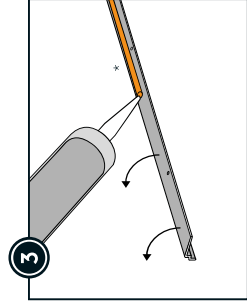
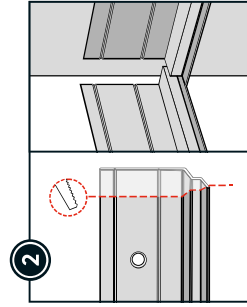
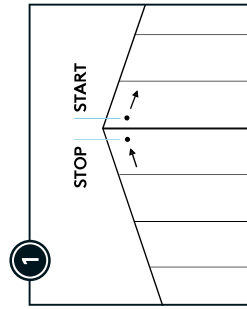

Crucial step to ensure a watertight result.

* Fibo Adhesive can be used instead of Fibo Seal.

Pre-cut surfaces and panel bottom edge.

Screw distance c/c 200 mm. Mind the force of drilling to avoid excessive screw penetration. Avoid use of excessive force when installing. This may harm the Aqualock.

First screw through base profile.

* If backwall with strips, bead must be 18 mm. With board backwall the bead should be 6 mm. ** Fibo Adhesive can be used instead of Fibo Seal.

FINISH!

NB: Det anbefales bruk av vuggende bevægelse når man klikker panelene sammen for å sikre en god sammenføyning av Aqualock. Bruk av Fibo Grip vil gi økt kontroll under sammenføyning. Ved behov kan man slå forsiktig mot spikerleppen på høyre side av panelet med Fibo Tapping Tool for å sikre at panelet er helt i lås.

NB: It is recommended to use a cradling movement back and forth when clicking the panels together to ensure a good joining of the Aqualock. Using Fibo Grip will give increased control during joining. If necessary, you can carefully tap the nail lip on the right side of the panel with the Fibo Tapping Tool to ensure that the panel is completely locked.

5C

MONTERING MED STANDARD INNVEDIG HJØRNEPROFIL INSTALLATION WITH STANDARD INTERNAL CORNER PROFILE



Velg en av våre hjørneprofiler: To-delt, skjult eller standard
Choose one of the following Corner Profiles: Two-part, hidden or standard

1 STOP | START

2

3

4 Crucial step to ensure a watertight result.

5

6 Preset cut surfaces and panel bottom edge.

7

8

9

10

11 First screw through base profile.

12 Screw
Sealant

13

14 Remove residue from cleaning / rengjøringsmiddel

15

16

17

18 Screw distance c/c 200 mm. Mind the force of drilling to avoid excessive screw penetration.

NB: Det anbefales bruk av vuggende bevegelse når man klikker panelene sammen for å sikre en god sammenføyning av Aqualock. Bruk av Fibo Grip vil gi økt kontroll under sammenføyning. Ved behov kan man slå forsiktig mot spikerleppen på høyre side av panelet med Fibo Tapping Tool for å sikre at panelet er helt i lås.
NB: It is recommended to use a cradling movement back and forth when clicking the panels together to ensure a good joining of the Aqualock. Using Fibo Grip will give increased control during joining. If necessary, you can carefully tap the nail lip on the right side of the panel with the Fibo Tapping Tool to ensure that the panel is completely locked.

Avoid use of excessive force when installing.
This may harm the Aqualock.